

FIELD INSPECTION REPORT

Project Name:	Mountain Valley Pipeline	Inspector:	Matthew Grant
Inspection Date:	Monday, May 23, 2022	Project Contact:	Brian Clauto
Spread G: Giles	ATWS 1390,1391, 816 AR-GI 240, 241, 241.04, GI-234	Weather:	Rainy

ACTIVE STAGE OF CONSTRUCTION: (Check all that apply)

- | | | | | |
|---|--|--|--|---|
| <input type="checkbox"/> Tree Felling | <input type="checkbox"/> Clearing/Grubbing | <input type="checkbox"/> Grading | <input type="checkbox"/> Trenching | <input type="checkbox"/> Stringing/Welding |
| <input type="checkbox"/> Lowering/Backfilling | <input type="checkbox"/> Final Grading | <input type="checkbox"/> Temp. Stabilization | <input type="checkbox"/> Perm. Stabilization | <input checked="" type="checkbox"/> Dormant |

- | | Yes | No | N/A |
|--|-------------------------------------|-------------------------------------|--------------------------|
| 1. Are controls installed and implemented in accordance with the approved erosion and sediment control plan and stormwater management plans? | <input checked="" type="checkbox"/> | <input type="checkbox"/> | <input type="checkbox"/> |
| 2. Are all control measures properly maintained in effective operating condition in accordance with good engineering practices and, where applicable, manufacturer specifications? | <input checked="" type="checkbox"/> | <input type="checkbox"/> | <input type="checkbox"/> |
| 3. Areas of offsite sediment deposition observed? | <input type="checkbox"/> | <input checked="" type="checkbox"/> | <input type="checkbox"/> |

- Comments: Inspected the following resources: S-G32, S-Q14, S-G33
- ECD's were in place and functioning at the designated crossings.

Routine Maintenance: (72-Hour Deadline from Notification)

- N/A

Ineffective Controls: (24-Hour Deadline from Notification)

- N/A

Recommended Corrective Action: N/A

Deadline: N/A

The recommended corrective action deadline date applies to all conditions noted on this report unless otherwise noted. If listed condition(s) currently constitute non-compliance and/or corrective actions are not completed by the deadline, other enforcement actions may be issued to the entity responsible for ensuring compliance on the above project.

Inspector Signature: _____  _____

Date: Monday, May 23, 2022

FIELD INSPECTION PHOTO LOG

Project Name: Mountain Valley Pipeline

Date: Monday, May 23, 2022

Figure 1: Designated crossing S-G32, ESC's are in place and functioning.



Figure 2: Above designated crossing S-Q14, ESC's are in place and functioning.

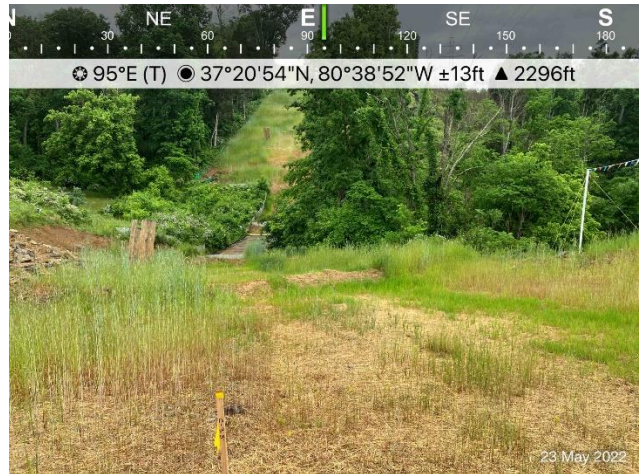

Figure 3: Designated crossing S-G33, ESC's are in place and functioning.



Figure 4: AR GI-234 ECD P1 remains in place.

